

## *The most robust cleaver*

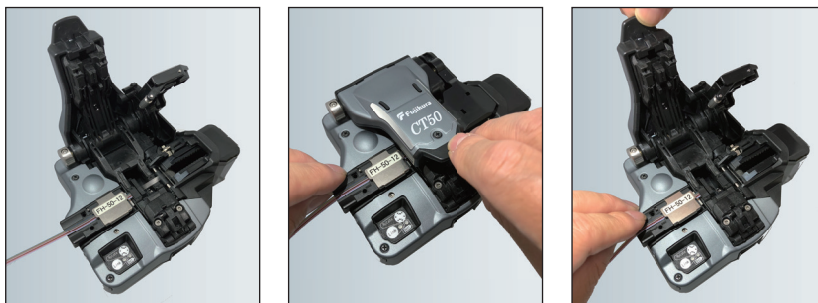

*Fiber Cleaver*

# *Fujikura CT50*



- Applicable for up to 12-fiber cleaving
- Automatic cleaving blade rotation via wireless communication
- User replaceable fiber clamps and cleaving blade
- Blade life up to 60,000 cleaves
- Wide lever opening angle allows easy fiber placement
- Single-action operation including fiber scrap collection



# Fujikura CT50

## SPECIFICATIONS

Description	CT50
Applicable optical fiber	Silica optical fiber
Fiber count	Up to 12
Cladding diameter	125 μm
Coating diameter	160 to 900μm 2 to 3mm cord and drop cable
Cleaving length	AD-50 5mm to 20mm (coating diameter =250μm) 10mm to 20mm (coating diameter > 250μm)
	Fiber holder 10mm (from the edge of FH:13mm)
Cleaving angle*1	Single fiber: Typical 0.7 degrees 12 ribbon fibers: Typical 1.0 degrees
Blade life	Typical 60,000 fibers (1,250 fibers x 3 heights x 16 positions)
Wireless connectivity	Bluetooth® 4.1 LE*2
Power supply	AAA (LR03) dry battery: 2pc
Dimensions	120(W) x 95(D) x 58(H)mm
Weight	300g
Operation condition	0 to 95% RH and 0 to 40°C (non-dew)
Storage condition	0 to 95% RH and -40 to 80°C (non-dew)
Resistance features*3	Shock: 76cm (30inch) all directions drop
	Dust resistance: Exposure to dust (0.1 to 500μm dia. Alumina Silicate)
	Rain resistance: H=10mm/hr for 10min

\*1 The optical fiber type, the blade condition or the operating environment may affect the cleaving angle.  
Since the measuring device has been changed from an interference microscope to a fusion splicer, this specification value is now higher than that of the previous model (CT-30).

\*2 The Bluetooth wireless connection of this product is not guaranteed to work with all smartphones or other devices.

\*3 The shock resistance test does not guarantee the product will not be damaged under these conditions.

• Bluetooth® and Bluetooth logo is a registered trademark of Bluetooth SIG, Inc.



## STANDARD PACKAGE

Description	Model No.	Qty.
Fiber plate	AD-50	1pc
Spacer	SPA-CT08-10	1pc
Carrying case	CC-37	1pc
Hexagonal wrench	HEX-01	1pc
Instruction manual	M-CT50-E	1pc

## OPTIONAL ITEMS

Description	Model No.
Blade	CB-08
Arm set	ARM-CT50-01
Dust box	FDB-05
Blade rotary wheel	BRW-CT08-01
Side cover	SC-CT50-01

## STANDARD PACKAGE



## OPTIONAL ITEMS



## FIBER HOLDERS

Description	Model No.
Applicable fiber holder	FH-50-xxx
	FH-60-xxx
	FH-100-xxx



Please visit **NEW** web site!

<https://www.fusionsplicer.fujikura.com>



Facebook

<https://www.facebook.com/FujikuraFusionSplicers>



twitter

<https://twitter.com/fujikurasplicer>

Specifications and descriptions are subject to change without prior notice. ©2018 Fujikura Ltd.

**Fujikura Ltd.**

1-5-1, Kiba, Koto-ku, Tokyo 135-8512, Japan  
Phone: +81-3-5606-1164 Fax: +81-3-5606-1534 <http://www.fujikura.com>

**Fujikura Asia Ltd.**

438A Alexandra Road, Block A Alexandra Technopark #08-03 Singapore 119967  
Phone: +65-6-278-8955 Fax: +65-6-278-0965 <http://www.fujikura.com.sg>

**Fujikura Europe Ltd.**

C51 Barwell Business Park, Leatherhead Road, Chessington, Surrey KT9 2NY, UK  
Phone: +44-20-8240-2000 Fax: +44-20-8240-2010 <http://www.fujikura.co.uk>

**AFL**

260, Parkway East, Duncan, SC29334, USA  
Phone: +1-800-235-3423 Fax: +1-800-926-0007 <http://www.aflglobal.com>

**Fujikura (China) Co., Ltd.**

7th Floor, Shanghai Hang Seng Bank Tower, 1000 Lujiazui Ring Road, Pudong New Area, Shanghai, 200120 CHINA  
Phone: +86-21-6841-3636 FAX +86-21-6841-2070