

Recepteur fibre 1550nm pour LNB quatro+Terrestre

This is a modular CWDM broadband RF fiber link, transmitting four 950~2150MHz Satellite RF and one 88~806MHz Terrestrial TV RF over one SM fiber to multi subscribers.

With CWDM lasers/photodiode and low noise RF gain control circuit, one TST-1550T-5 can deliver high quality RF to maximum 32 TST-1550R-5 optic receivers directly.



Features:

- Compact aluminum housing
- Quattro LNB and Terr TV over one SM fiber transmission
- VL/VH/HL/HH bandwidth: 950MHz to 2150MHz
- Terrestrial TV bandwidth: 88~806MHz (including FM)
- 1530nm/1550nm/1570nm/1590nm CWDM system
- CWDM uncooled DFB Laser
- AGC on optical transmitter and receiver
- High Linearity Photodiode
- Excellent RF Isolation
- Low noise RF Gain Control circuit

Application:

OPTICAL SATELLITE SYSTEM

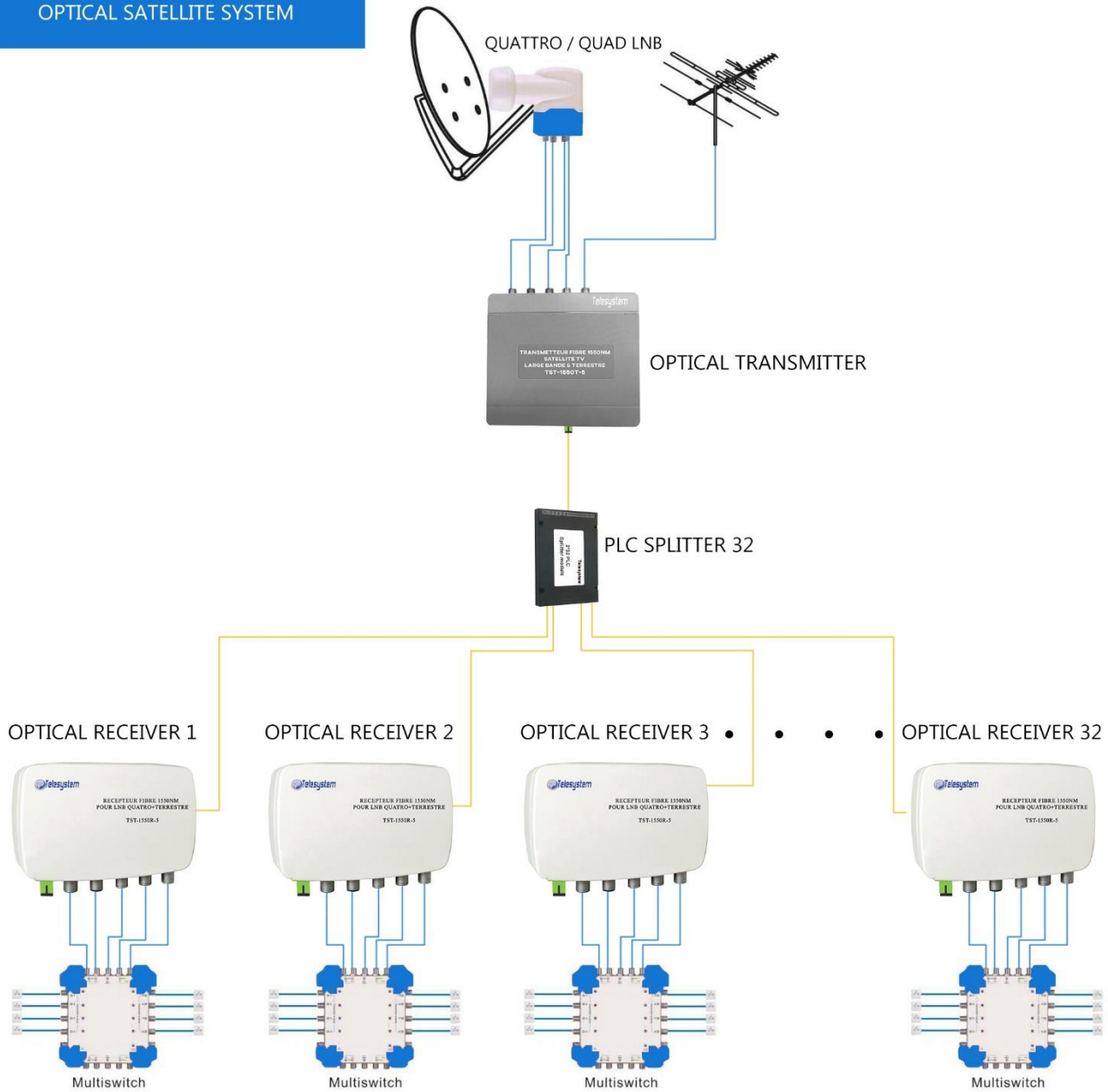

Specifications:

TST-1550T-5 Optical Transmitter

RF Input	
RF Input Port Number	Sat Quattro/Quad inputs and one Terrestrial TV Input
RF Bandwidth at each port	Satellite: 950~2150MHz Terrestrial TV: 88~806MHz
Minimum RF Input Power	-50dBm
Maximum RF Input Power	-30dBm
RF Connector	F-Type, American Female
RF Return Loss	10dB
RF Impedance	75 Ohm
Power on LNB	13V 0Hz, 18V 0Hz, 13V 22KHz, 18V 22KHz
RF AGC	Preset at 35 RF carriers in the bandwidth
AGC Flatness	±3.0 dB
Optics	
Optical Output Port	One
Fiber	9µm / 125µm Single Mode Fiber
Fiber Connector	SC/APC

Output optical wavelength	1530nm/1550nm/1570nm/1590nm
Laser	Uncooled DFB laser with one stage isolator
Laser Output Power	>5dBm (each CWDM wavelength)
LED Status	6 Green Color LED on the panel, representing DC Power, RF1, RF2, RF3, RF4, RF5. LED "ON" when there is the corresponding signal.
Physical	
Power Supply	19V 2A DC Power Adaptor
Power Consumption	15W
Dimensions (W x H x D) mm	300 x 30 x 180
Operating Temperature (°C)	-20 - +60
Storage Temperature (°C)	-40 - +85
Humidity	10%~90% non-condensing
Weight	1.5Kg (without power adaptor)